

# CLHS Parent Drop-off/Pick-Up Procedures

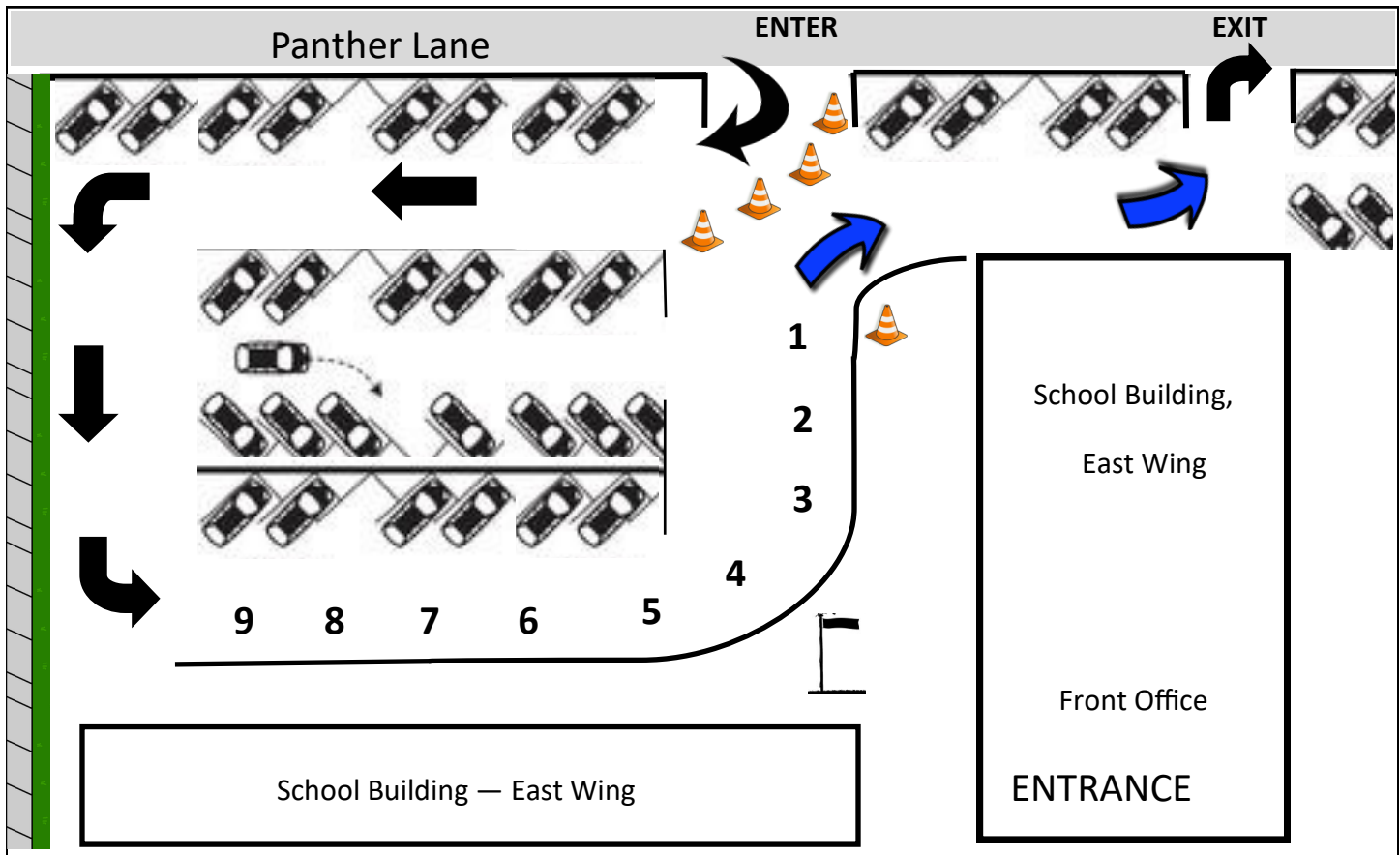

1. Turn right into the front circle area and make an immediate right to go around the circle.
2. Please do not pull out and pass any other cars unless directed to do so by school staff.
- 3. Pick up by the curb, in sidewalk areas marked 1-9 on map above. Do not pick up your student in the parking lot or ask them to walk out to your car on the street.**
4. Pull forward as the line moves to keep the traffic flow.
5. Please pull forward all the way to spot #1 if you are waiting for your student.
6. At the second gate, turn RIGHT to exit campus.
7. Please NOTE: from 6:40-7:05 & 1:30-2:00, only TURN RIGHT to exit campus.

## Safety Reminders:

- All traffic needs to stay on the right (legal) side of the street. Please do not pull out of line to pass cars in front of you, thereby putting you in the lane of oncoming traffic.
- Please be patient and wait in line. **DO NOT allow your child to get out on Panther Lane.** This is dangerous!
- Please do not park your car in the pick-up line -- with or without the engine running. All parents should remain in their cars.
- Students should be picked up at the designated area only (area #1-9 on sidewalk map above) . Please do not instruct your child to walk to another spot to be picked up. Do NOT pick up on the street.

KEEP OUR PANTHERS **SAFE!!**